

Stringybark Road pedestrian and cycle bridge, Sippy Downs

Overview

Construction will soon commence on a new pedestrian and cycle bridge running parallel and to the east of the existing Stringybark Road bridge, which spans across the Sunshine Motorway between Buderim and Sippy Downs.

This new three-metre-wide bridge will provide a shared pathway for bicycle riders and pedestrians, separate from vehicles.

This \$11.8 million project is proudly supported by the Queensland Government's Cycle Network Local Government Grants program and Sunshine Coast Council.

Project scope

The new stand-alone bridge completes a missing link in the Sunshine Coast's cycle network by providing a dedicated pedestrian and cycle path to replace the narrow pathway on the existing vehicle bridge. It will make it easier and safer for people of all ages and abilities to walk and ride for recreation and wellbeing.

The new bridge will include architecturally designed decorative elements that complement the surrounding area and provide a safety barrier for the Sunshine Motorway.

The decorative elements are influenced by the forest canopy and birds in the area and will cast patterns onto the bridge during the day and night. At night the bridge will be softly lit to ensure safety and clear sight lines for all users.

In addition to the new bridge, the pathway on the existing vehicle bridge will be removed and the bridge reconfigured to provide on-road cycle lanes on both sides.

To minimise inconvenience to our community the many of bridge components will be prefabricated off-site and then assembled in place. In this way lengthy on-site construction times and equipment are avoided.

View the artist impressions of the bridge on pages 2 and 3 of this newsletter.

Construction schedule

Construction is scheduled to commence in early March 2024. Completion is expected by November 2024 (weather and site conditions permitting).

Works will be scheduled to minimise inconvenience to motorists, pedestrians and cyclists.

Following a public tender process in 2023, the bridge will be constructed by Queensland Bridge and Civil, a highly experienced bridge contractor who has constructed many similar bridges throughout South East Queensland.

Access during construction

Traffic movements will remain open on Stringybark Road and the Sunshine Motorway for the duration of the construction period.

Some road lane closures and delays will be experienced throughout the construction period due to safety reasons. Lane closures will be primarily scheduled at night to minimise inconvenience.

Nearby residents, motorists and cyclists will be notified of upcoming lane closures and delays via electronic signage and/or traffic control with motorists encouraged to use alternate routes during these times to minimise delays.

Work hours will generally be 6am – 6pm Monday to Saturday. Works outside these times may be required occasionally.

For safety reasons construction fencing will be erected around the construction zone for the duration of the construction period.

Access to the existing bridge's shared pathway will remain open for pedestrians and cyclists during the new bridge's construction.

Environmental considerations

Some trees will need to be removed to allow for construction of the new pedestrian and cycle bridge. These trees will be replaced with offset planting on the Sunshine Coast, with more trees planted than those removed.

A fauna spotter will be present during clearing operations.

Keep informed

You can find further information about the Stringybark Road pedestrian and cycle bridge project and construction notices on Council's website at www.sunshinecoast.qld.gov.au

Simply scan the QR Code below to be taken directly to the webpage.



The QR Code will also be displayed on signs on the existing bridge for pedestrians and cyclists to scan and link to the webpage for further information.

Further information

To contact Council's project team directly please

Email:

stringybarkbridge@sunshinecoast.qld.gov.au

or contact Council's customer service via the details below (please quote Stringybark Road pedestrian and cycle bridge).

Sunshine Coast Council

www.sunshinecoast.qld.gov.au

mail@sunshinecoast.qld.gov.au

T 07 5475 7272 F 07 5475 7277

Locked Bag 72 Sunshine Coast Mail Centre Qld 4560



Figure 1: Artist impression (aerial view) of the new, stand-alone pedestrian and cyclist bridge to be constructed on the eastern side of the existing Stringybark Road bridge.



Figure 2: Artist impression of the new pedestrian and cyclist bridge when looking west, toward the existing Stringybark Road bridge.



Figure 3: Decorative elements create patterns of light and shade as well as providing protection for users.

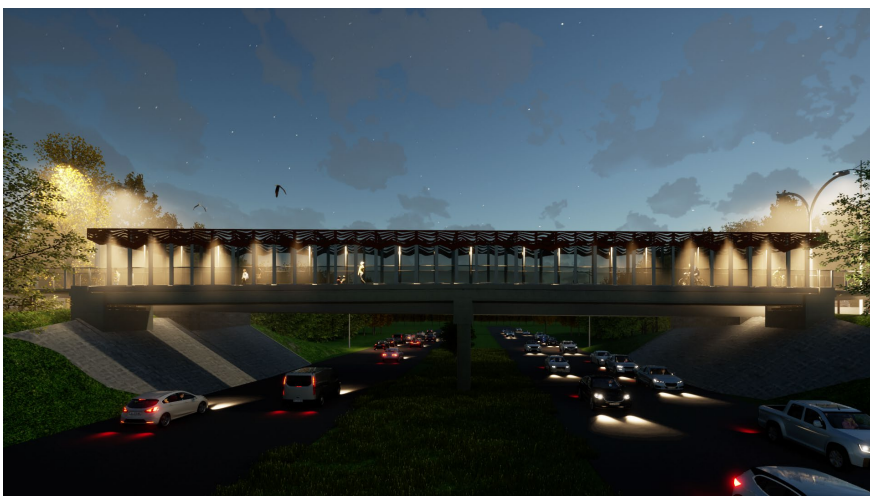

Figure 4: At night the bridge will be softly lit for user safety.